

Kambook - Australia

Building 2, Port Air Industrial Estate
1A Hale Street
Botany NSW 2019
Australia
Customer Service Line 1300 139 798
Customer Service Fax 1800 621 337

www.kambook.com.au

Kambook - New Zealand

Private Bag 94411
Botany, Manukau
Auckland 2163
New Zealand
Customer Service Line/
Spare Parts 0800 273 845
Customer Service Fax 0800 288 513

www.kambook.co.nz

KAMBROOK
THE SMARTER CHOICE

Due to continual improvement in design or otherwise, the product you purchase may differ slightly from the illustration in this book. Issue D11

KAMBROOK

THE SMARTER CHOICE



Arctic
40cm
Pedestal Fan

Suits all KFA413 models

Instruction Booklet

Contents

Kambrook Recommends Safety First	p3
Your Kambrook Arctic Pedestal Fan	p5
Using Your Kambrook Arctic Pedestal Fan	p6
Care and Maintenance	p7

Important

Please retain your instruction book for future use.

In the event that you need some assistance with your Kambrook appliance, please contact our Customer Service Department on 1300 139 798 (Australia) or 0800 273 845 (New Zealand). Alternatively, visit us on our website at www.kambrook.com.au or www.kambrook.co.nz

Kambrook Recommends Safety First

IMPORTANT: Please retain your instruction book for future use.

At Kambrook, we believe that safe performance is the first priority in any consumer product, so that you, our valued customer can confidently use and trust our products. We ask that any electrical appliance that you use be operated in a sensible fashion with due care and attention placed on the following important operating instructions.

Important Safeguards For Your Kambrook Arctic Pedestal Fan

- Carefully read all instructions before operating the Kambrook Arctic Pedestal Fan for the first time and save for future reference.
- To protect against electric shock, do not immerse the fan, cord or plug in water or any other liquid
- This fan is intended for household use only and not for commercial or industrial use. Disconnect the power plug before dismantling, assembling or before cleaning and when the fan is not in use.
- Avoid touching mobile parts of the fan.
- Ensure the fan is on a dry and even surface.
- Never insert fingers, pencils or any other objects through the guards whenever the power plug is connected, in particular while the fan is switched on.
- The fan must not be used if the guards are not fastened correctly, according to these instructions.
- Do not operate in the presence of explosives and/or flammable fumes or liquids.
- Do not unplug the fan by pulling on the cord.
- Never leave the fan unattended when in use.
- Never carry the fan by the cord or yank to disconnect from an outlet; instead, grasp the cord and pull to disconnect. Do not pull the cord around sharp edges or corners.

Important Safeguards For All Electrical Appliances

- Carefully read all instructions before operating the appliance and save for future reference.
- Remove and safely discard all packaging material and promotional labels before using the appliance for the first time.
- Fully unwind the power cord before use.
- Do not let the power cord hang over the edge of a bench or table, touch hot surfaces or become knotted.
- To protect against electric shock, do not immerse the power cord, power plug or appliance in water or any other liquid, unless it is recommended in the cleaning instructions.
- The appliance is not intended for use by persons (including children) with reduced physical, sensory or mental capabilities, or lack of experience and knowledge, unless they have been given supervision or instruction concerning use of the appliance, by a person responsible for their safety.
- Children should be supervised to ensure that they do not play with the appliance.
- It is recommended to inspect the appliance regularly. Do not use the appliance if the power supply cord, plug, connector or appliance becomes damaged in anyway. Return the entire appliance to the nearest authorised Kambrook Service Centre for examination and/or repair.
- Any maintenance other than cleaning should be performed at an authorised Kambrook Service Centre.
- This appliance is for household use only. Do not use this appliance for other than its intended use. Do not use in moving vehicles or boats. Do not use outdoors.
Misuse may cause injury.
- The installation of a residual current device (safety switch) is recommended to provide additional safety protection when using electrical appliances. It is advisable that a safety switch with a rated residual operating current not exceeding 30mA be installed in the electrical circuit supplying the appliance. See your electrician for professional advice
- Always turn the appliance to the OFF position, switch off at the power outlet and unplug at the power outlet when the appliance is not in use.
- Before cleaning, always turn the appliance to the OFF position, switch off at the power outlet, unplug at the power outlet and remove the power cord, if detachable, from the appliance and allow all parts to cool.
- Do not place this appliance on or near a heat source, such as hot plate, oven or heaters.
- Position the appliance at a minimum distance of 20cm away from walls, curtains and other heat or steam sensitive materials and provide adequate space above and on all sides for air circulation.

Your Kambrook Arctic Pedestal Fan (KFA413 shown)

- 1. Fan blade size: 40cm
- 2. Choice of 3 speed settings
- 3. 80° oscillation to disperse the air throughout the room
- 4. Easy twist controller switch
- 5. Height adjustable for comfort control
- 6. Tilt adjustable head to control the direction of the air
- 7. Metal grille and plastic blades
- 8. Convenient carry handle for easy portability

Parts List

- 9. Front grille with securing clips and screw
- 10. Rear grille
- 11. Blade cap and guard locking nut
- 12. Plastic fan blade
- 13. Motor head and stand
- 14. Pedestal extension tube
- 15. Height adjustment ring
- 16. 2 piece criss-cross base
- 17. Criss-cross collar

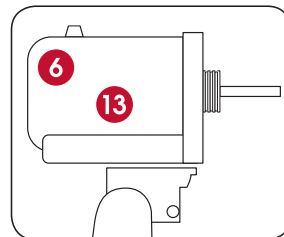
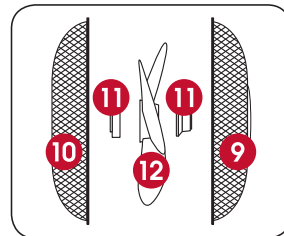
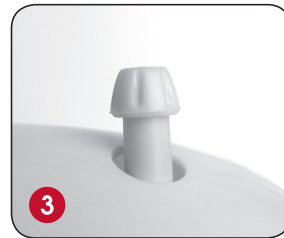

Using Your Kambrook Arctic Pedestal Fan

Before First Use

Remove any promotional material from the fan.



IMPORTANT: When unpacking the fan, check to see you have received all the items listed in the Parts List, before discarding the packaging.

Assembling Your Arctic Pedestal Fan

Base and Pedestal Tube Assembly

1. Interlock the criss-cross bases. Remove the four screws from the criss-cross bases, and align these four holes with those on the flange. Secure the flange to the criss-cross bases with the four screws. This might require a bit of force.



2. Loosen and remove the Height Adjustable Ring. Slide the criss-cross collar over the support tube. (Fig. 2) Extend the support tube. A bit of force may be required to grasp the support tube, located inside the Pedestal Extension Tube. Re-attach and tighten the Height Adjustment Ring to prevent slipping.

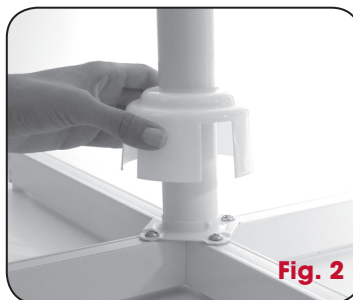

3. Place the motor head housing onto the Pedestal Extension Tube.
4. Tighten the screw to secure the motor head housing to the Pedestal Extension Tube.

Fan Head Assembly

1. Remove the Blade Cap from the Motor shaft by turning it clockwise, and then remove the Guard Locking Nut by turning it anti-clockwise.
2. Thread the Motor shaft through the centre hole of the Rear Grille, placing the Rear Grille into position. Make sure that the carry handle, on the back of the Rear Grille is located above the motor housing. Ensure the Rear Grille is aligned with the locating pins and fix the grille into position by replacing the Guard Locking Nut. Make sure that the Rear Grille has not slipped off the locating pins before tightening. This should be done by hand. Do not force.

NOTE: When positioning the Rear Grille on the Motor shaft, always ensure the carry handle on the grille is positioned in the upright position.

3. Insert the Plastic Blade onto the Motor shaft, and match the pin slots in the blade with the Motor shaft pin.
4. Fix the blade into place by tightening the Blade Cap onto the Motor shaft in an anti-clockwise direction. This should be done by hand. Do not force.

5. Unlatch the Securing Clips on the Front Grille and unscrew the small screw located at the bottom of the front guard.
6. Align and press together the Front and Rear Grille, and secure by snapping shut the Securing Clips over edges of both grilles. Make sure that the small holes at the bottom of both grilles are aligned. Tighten the Securing Clips by hand.
7. Thread the screw through the small holes of both the front and back grilles, and tighten using the nut provided.

To Operate the Arctic Pedestal Fan

Plug the cord into a 230V or 240V power point and switch on.

NOTE: To avoid an electrical circuit overload, it is recommended that no other appliances are plugged into the same circuit as your fan when it is in use.

Use the Twist Controller Switch to select the desired air flow speed setting.

- 0 – The fan is in the 'OFF' position
- 1 – Low
- 2 – Medium
- 3 – High



Setting the Oscillation

The oscillation function works in all air flow settings.

Press down the Oscillation switch to activate. The fan will begin to oscillate from side to side.

Lift the Oscillation switch to stop the fan from oscillating.

NOTE: The Oscillation switch is located behind the Rear Grille, on the Motor head housing.

Adjustable Tilting Head

The Arctic Pedestal Fan incorporates an Adjustable Tilt Head for greater air coverage.

To adjust the angle of the head, while securely holding the shaft of the pedestal tube, simply lift or lower the Motor head housing, the head will click as it is being adjusted.

Adjustable Height

The Arctic Pedestal Fan height can be adjusted.

Simply loosen the Height Adjustable Ring on the Pedestal Tube of the fan. Then adjust to the required height. Re-tighten the Height Adjustable Ring when the desired height has been reached.

Care and Maintenance

Always switch the Arctic Pedestal Fan off, prior to cleaning the housing, base, grilles and blades.

To clean the outside of the fan, wipe the exterior with a soft, damp cloth. Never use an abrasive cleaner.

When not in use, store the fan (preferably in its original box) in a cool, clean and dry location.